

CENTAURSLAM[®] TUBE

Technical data

Product model	Dimensions / mm	
	L	Ø
CentaurSlam [®] Tube 1x18W	335	115
CentaurSlam [®] Tube 1x36W	540	115
CentaurSlam [®] Tube 2x36W	740	115
CentaurSlam [®] Tube Linear 2x36W	1020	115

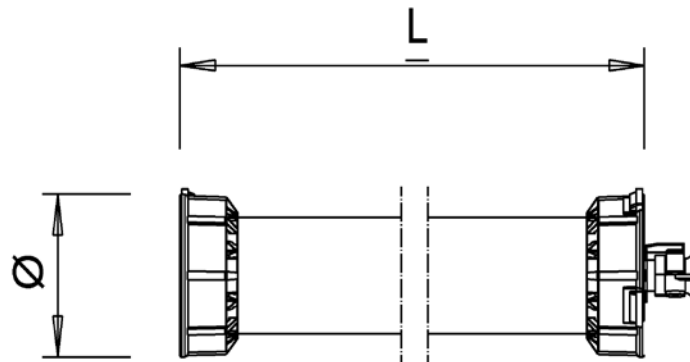

Standard specifications

Ingress protection
 Operating temperature
 Light source
 Ballast

**IP 66 (without socket), IP44 (with socket)
 -20°C to +40°C**

Compact fluorescent lamp, color temperature 4000K

Electronic. 110VAC and 230VAC A versions also available with magnetic ballast.

Plug and socket options
 Cable

**ABL, Mennekes, Norvo, Strömfors, Walther, Wieland
 H07RN-F (other types available on request)**

Centaurea Oy

P.O. Box 89
 FIN-60101 Seinäjoki
 Finland

Tel. + 358 (0)6 421 2400
 Fax: + 358 (0)6 414 0631
 www.centaurea.fi

Trade Reg. No. 486.515
 VAT No. FI08370823

CentaurSlam® Tube 1x18W

Light output **1200 lumens**
Input voltage **AC 230V (50/60Hz)**
AC/DC 110V, 42V, 24V
3P, 2P+E or 2P configuration
Weight **Approx. 1.25kg (without cable or accessories)**
Variants **A (Cable in – without socket)**
C (Cable in – socket out), linkable



CentaurSlam® Tube 1x36W

Light output **2900 lumens**
Input voltage **AC 230V (50/60Hz)**
AC/DC 110V, 42V, 24V
DC 12V
3P, 2P+E or 2P configuration
Weight **Approx. 1.55kg (without cable or accessories)**
Variants **A (Cable in – without socket)**
C (Cable in – socket out), linkable



CentaurSlam® Tube 2x36W

Light output **5800 lumens**
Input voltage **AC 230V (50/60Hz)**
AC/DC 110V, 42V, 24V
3P, 2P+E or 2P configuration
Weight **Approx. 2.55kg (without cable or accessories)**
Variants **A (Cable in – without socket)**
C (Cable in – socket out), linkable



CentaurSlam® Tube Linear 2x36W

Light output **5800 lumens**
Input voltage **AC 230V, (50/60Hz)**
AC/DC 110V, 42V, 24V, 12V
3P, 2P+E or 2P configuration
Weight **Approx. 3.0kg (without cable or accessories)**
Variants **A (Cable in – without socket)**
C (Cable in – socket out), linkable



Centaurea Oy

P.O. Box 89
FIN-60101 Seinäjoki
Finland

Tel. + 358 (0)6 421 2400
Fax: + 358 (0)6 414 0631
www.centaurea.fi

Trade Reg. No. 486.515
VAT No. FI08370823

Informational purposes only. Centaurea reserves the right to change the specifications without notice.

CENTAURSLAM®
TUBE