



EE11 PL with eXLink

EE11 PL

AB 12108-EVG

**Technical data**

**AB 12108-EVG**

Marking to 94/9/EC (new standard – applies for)	⊕ II 2 G EEx d IIC T6/T5 / ⊕ II 2 D T 58 °C (T <sub>a</sub> up to 40 °C) T 73 °C (T <sub>a</sub> up to 55 °C) <sup>1)</sup> ⊕ II 2 G Ex d IIC T5/T6 / ⊕ II 2 D Ex tD A21 IP67 T73 °C
EC-Type Examination Certificate	LOM 02 ATEX 2013 X
Permissible ambient temperature	-20 °C up to +55 °C
Rated voltage 1	230 V AC
Rated voltage 2	220 V DC +25 %/-20 %
Frequency	50 Hz
Rated power consumption	approx. 16 VA
Connecting terminals	L1, N and PE: 2 x 2.5 mm <sup>2</sup> / PE ext.: 2 x 6 mm <sup>2</sup>
Insulation class	I
Lamp/Illuminant	1 x 8 W/T5-fluorescent lamp for mains and emergency operation
Lamp cap	G5
Luminous flux Φ <sub>E</sub> /Φ <sub>N</sub> at the end of rated operating time	75 %
Viewing distance with legend	up to approx. 15 m
Degree of protection accd. EN 60529	IP67
Cable glands/gland plates/enclosure drilling	direct entries: see ordering details
Dimensions (L x W x H)	460 x 144 x 140 mm
Weight	approx. 5.3 kg
Enclosure material	copper-free aluminium
Protective cover/protective bowl	borosilicat-glass

**EE11 PL**

Marking to 94/9/EC (new standard – applies for)	⊕ II 2 G EEx d IIC T6 / ⊕ II 2 D T 58 °C ⊕ II 2 G Ex d IIC T5/T6 / ⊕ II 2 D Ex tD A21 IP67 T73 °C
EC-Type Examination Certificate	LOM 03 ATEX 2036 X
Permissible ambient temperature	-5 °C up to +40 °C
Rated voltage 1	220 V - 240 V AC
Rated voltage (option)	108 V - 127 V AC
Frequency	50 - 60 Hz
Rated power consumption	approx. 16 VA
Connecting terminals	L1, N and PE: 2 x 2.5 mm <sup>2</sup> / PE ext.: 2 x 6 mm <sup>2</sup>
Insulation class	I
Lamp/Illuminant	1 x 11 W compact-fluorescent lamp for emergency operation
Pilot lamp	3 W – GLS for permanent operation
Lamp cap of 11 W C FL	socket 2G7
Luminous flux in emergency operation	approx. 70 % after 1.5 h
Viewing distance with legend	up to approx. 15 m
Battery	nickel-cadmium 4 Ah
Rated operating in emergency	1.5 h
Charging duration	24 h
Degree of protection accd. EN 60529	IP67
Cable glands/gland plates/enclosure drilling	see ordering details, eXLink inlet on request
Dimensions (L x W x H)	460 x 144 x 140 mm
Weight	approx. 5.6 kg
Enclosure material	copper-free aluminium
Protective cover/protective bowl	borosilicat-glass
Function indication	red LED      battery charging green LED    main connection

Note: EE11PL Luminaire must not be opened in hazardous area.

<sup>1)</sup> Marking accd. new standard applies for

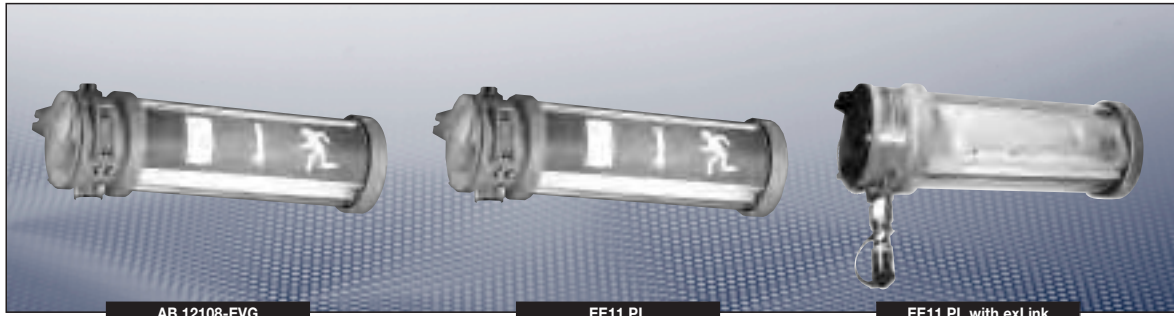

AB 12108-EVG

EE11 PL

EE11 PL with exLink

## Ordering details

Type	Rated voltage	Thread	Cable gland Ex-d for Ø 9 - 14 mm	Blanking plug Ex-d	Ordering Code
<b>AB12108-EVG</b>					
AB12108-EVG	220 - 230 V AC /	2 x 3/4"	1 x 3/4"	1 x 3/4"	<b>NOR 000 005 060 837</b>
AB12108-EVG	195 - 250 V DC	2 x 3/4"	–	1 x 3/4"	<b>NOR 000 005 060 820</b>
<b>EE11 PL</b>					
EE11PL	220 - 240 V AC	2 x 3/4"	1 x 3/4"	1 x 3/4"	<b>NOR 000 005 160 012</b>
		2 x 3/4"	–	1 x 3/4"	<b>NOR 000 005 160 013</b>
EE11PL	108 - 127 V DC	2 x 3/4"	1 x 3/4"	1 x 3/4"	<b>NOR 000 005 160 015</b>
		2 x 3/4"	–	1 x 3/4"	<b>NOR 000 005 160 014</b>

## Accessories

### Ex-Emergency luminaires AB 12108-EVG and EE11 PL

Type	Ordering Code
Ceiling bracket D 92 with screws and polyamide washer (CrNi, 2 pcs.)	<b>2 2480 092 000</b>
Ceiling bracket A5 hot galvanized (1 pc.)	<b>NOR 000 005 009 162</b>
Wall bracket 45° hot galvanized (1 pc.)	<b>NOR 000 005 009 196</b>
Reflector RAB 108 (AISI 304)	<b>NOR 003 045 060 471</b>
Reflector RAB 108 (AISI 304) + guard (steel white epoxy coating)	<b>NOR 003 045 060 819</b>
Reflector RAB 108 (AISI 316)	<b>NOR 003 165 060 471</b>
Reflector RAB 108 (AISI 316) + guard (steel white epoxy coating)	<b>NOR 003 165 060 819</b>

### Lamps for Ex-emergency and signal light fittings

For luminaire Type	Lamp type/ lamp cap/diameter	Lamp power	rated luminous flux approx.	Ordering Code
AB 12108-EVG	T5, socket G5, Ø 16 mm	8 W	450 lm	<b>4 0040 004 623</b>
EE11 PL	TC-SEL, 4-pin socket 2G7	11 W	900 lm	<b>on request</b>



**Dimension drawing | Polar curves | Accessories**

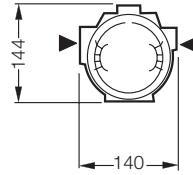
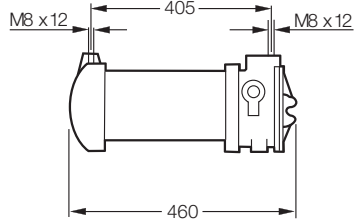

AB 12108-EVG / EE11 PL

**Polar curve**  
AB 12108-EVG / EE11 PL

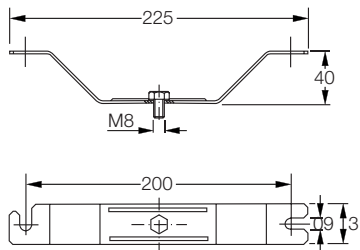
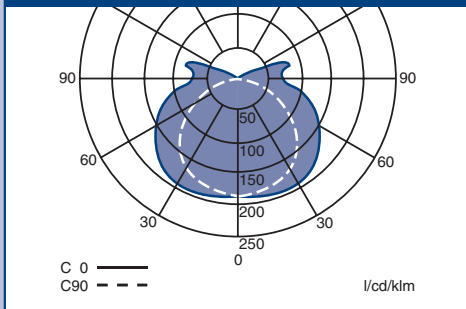

**Ceiling bracket D92**

Cooper Crouse-Hinds © 2009 - all rights reserved

Dimensions in mm

1  
2  
3  
4  
5  
6  
7  
8  
9  
10  
11  
12